

# PVC REWRITABLE CARDS

Print temporary or updatable cards



These cards, thanks to a specific material, are re-writable and do not require any ribbon. The information can be erased in order to note down another printing elements on the same card. They are available with black or blue monochrome printing.

## ADVANTAGES

Evolis PVC rewritable cards bring you flexibility as you can deliver a new card anytime it is required. It is also a cost effective solution (no ribbon needed), that helps to reduce the environment footprint.

These cards are very useful for example in a fidelity program or for visitor badges, when the data change every customer's visit. You don't have to create a new card when the information is changing.

Tested and validated by Evolis R&D and Quality departments, these consumables bring you printing quality and reliability.

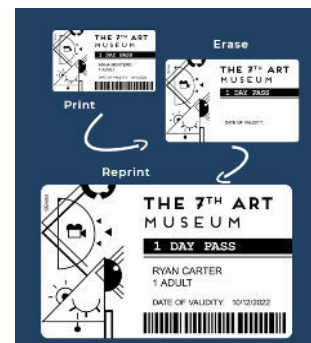

## GENERAL SPECIFICATIONS

### Rewrite technology:

The rewritable printing technology does not require any ribbon to personalize cards. The card itself holds a thermo sensitive material that turns visible when heated to a temperature of 356°F (180°C) and then rapidly cooled. The application of a lower temperature, generally in the 230-320°F (110-160°C) range, will erase any color pattern.

### Features:

- Cards in PVC with an Overlay PET Thermo Re-Writable – Blank white
- Compliant with ISO CR-80 (ISO 7810) standards
- Dimension: 85.6 mm Length x 54 mm Width (3 3/8" x 2 1/8")
- Thickness: 0.76 mm / 30 MIL
- Available in two printing colors, Blue (C5101) and Black (C5201)

## PRODUCT INFORMATION:

- PVC Cards Blank White
- 30 MIL
- Rewritable Blue (C5101) or Black (C5201)



## COMPATIBILITY AND PACKAGING

PART#	PACKAGE	PRINTING COLOR	PRIMACY 2	TATTOO RW
C5101	1 box of 100 cards	BLUE	•	•
C5201	1 box of 100 cards	BLACK	•	•

## STORAGE INFORMATION

The cards shall be capable of functioning for up to 2 years after purchase if stored in a cool, dry environment and having remained unopened from the original packaging.

Temperature of storage must be between 15-30°C and at RH between 10-60%.

Once opened, avoid dust, direct sunlight, high humidity and high temperatures.

Do not place near solvent or other chemicals.

## INSTRUCTIONS FOR USE

In order to optimize the printing quality and card durability:

- Do not use cards that have been damaged, folded or dropped on the floor.
- Do not touch the printable surface of the cards in order to preserve print quality.
- Do not use in high temperature conditions. Do not place near heat sources. Avoid thermal shock.



Evolis - 14 avenue de la Fontaine - Z.I. Angers-Beaucouzé 49070 Beaucouzé - France  
T +33 (0) 241 367 606 - F +33 (0) 241 367 612 - [info@evolis.com](mailto:info@evolis.com)

[www.evolis.com](http://www.evolis.com)